

A technical line drawing of the front portion of a bicycle, showing the handlebars, stem, front fork, and front wheel. The drawing is rendered in a sketch-like style with fine lines and some shading to indicate depth and form. The bicycle is positioned on the left side of the page, with the front wheel being the most prominent feature.

# **FISCHER**

*die fahrradmarke*

EN

## **ASSEMBLY AND QUICK START GUIDE**

**ORIGINAL OPERATING INSTRUCTIONS PEDELEC 2021**

# Contents

<b>Contents</b>	2	<b>Adjusting the seat</b>	2
<b>Legal disclosure</b>	2	Correct seat height	2
<b>Introduction</b>	3	Saddle tilt	2
<b>Safety Instructions</b>	4	Handle bar position / Stem	12
<b>Intended Use</b>	5	Suspension	13
Type 1: Trekking pedelecs	5	<b>Instructions about electrics and electronics</b>	13
Type 2: City and touring pedelecs	5	Charging process	13
Type 3: Mountain bike pedelecs	5	Charger	14
<b>Legal Regulations</b>	6	Maintenance and care	14
<b>Children</b>	6	<b>Before the first ride</b>	14
Children and pedelecs	6	<b>Mechanical components</b>	15
Carrying children/trailers for children	6	Back pedal brakes	15
<b>Unpacking</b>	7	Chain	15
<b>Assembly</b>	7	Brakes	15
Using quick releases	7	Gear change system	16
Handlebars with a quill stem	8	<b>Loose/mounted accessories</b>	16
Handlebars with an A-head stem	9	Luggage rack	16
Handlebars with a Speedlifter Twist	9		
Screw-on pedals	10		
Clip-in pedals	11		
Brake levers	11		

For any questions regarding your pedelec, please contact our service hotline (Germany: +49 721-97902560, Austria: +43 1 9073366).

# Legal disclosure

12 Fischer Quickstart Assembly Version 3.0  
12 January 2021

MTS Group, Inter-Union Technohandel GmbH, Carls-Benz-Straße 2, 76761 Rülzheim, Tel: +49 7272 9801-100, Fax: +49 7272 9801-123, [www.mts-gruppe.com](http://www.mts-gruppe.com)  
MTS Group Inter-Union Technohandel GmbH is represented by: Managing director: Jürgen Herrmann, Frank Jansen  
Responsible for distributing and marketing the operating instructions: inMotion mar.com  
Rosensteinstr. 22, 70191 Stuttgart, Germany  
[info@inmotionmar.com](mailto:info@inmotionmar.com), [www.inmotionmar.com](http://www.inmotionmar.com)  
Contents and illustrations: Veidt-Anleitungen, Friedrich-Ebert-Straße 32, 65239 Hochheim, Germany  
[anleitungen@thomas-veidt.de](mailto:anleitungen@thomas-veidt.de)  
Legal inspection by a lawyer's office specialising in intellectual property.  
This operating manual, in conjunction with the original operating manual and system manual, covers the requirements and scope of EN 15194:2018-11.  
In case of delivery and use outside this scope, the manufacturer of the vehicle must supply the requisite manuals. Subject to modifications. Last updated at publication 01/2021  
© Before reproducing, reprinting, translating or using this document for any commercial purpose (even in part, printed or electronic form), you must first receive written consent.

## Introduction

Your Pedelec has been carefully pre-assembled in the factory. For easier transport, some parts have been loosened and put in transport position. In order to get the Pedelec ready and safe to ride, these parts must be put into a normal position and fastened after the Pedelec is unpacked. Be sure to read this assembly manual carefully, keep it safely and follow all of the steps it describes.

These assembly instructions are applicable only together with the included operating instructions. Page numbers refer to the pages of the original operating instructions.

Carefully read this guide in its entirety before your first ride and keep it close to your pedelec so that it is always available. If you lend your pedelec to a third party, please give them this manual along with the pedelec.

You may use this assembly and quick start guide if you have a basic understanding of pedelecs. Once you have fully read and understood this guide, you may begin to use the pedelec. However, it is essential that you read the operating manual in its entirety as soon as possible.

You may have received your pedelec in various states of assembly. To ensure that it is in safe operating condition, all assembly and adjustment work need to be completed first.

For any major or safety-related work, contact our service hotline and leave this work to a specialist/ Fischer service technician.

This guide assumes that the users of this pedelec have a general, basic knowledge and understanding of how to use pedelecs and that they have fully read and understood the contents of this guide. This guide applies to the E-CITY / E-TREKKING / E-MTB models as indicated on the pack in which it came.

You will also find a wide range of information and videos about use, maintenance and settings of your pedelec online.



[www.fischer-fahrrad.de/mediathek](http://www.fischer-fahrrad.de/mediathek)



[www.youtube.com/user/FischerFahrradmarke](http://www.youtube.com/user/FischerFahrradmarke)

### **Note for parents and legal guardians:**

As your child's legal guardian, you are responsible for their actions and safety. This includes taking care of the pedelec's technical condition and supervising the rider.

In addition, you should also ensure that your child has learnt how to use the pedelec safely. They should know how to ride the pedelec properly and responsibly in the environment in which it will be used.

## Safety Instructions

First, a few pointers which the person using the pedelec should consider before starting a journey:

- Always wear a fitted and suitable bicycle/pedelec helmet and use it each time you ride.
- Any time you ride, always wear bright clothing or sports clothes with reflective elements. This is vital so that other people can see you.
- Tight clothing is mandatory; if you do not have any, use trouser clips. Your shoes should be slip-resistant and have hard soles.
- Never ride with headphones. Never use your phone while riding.
- Never cycle if you are unable to control your bike completely. Under no circumstances should you cycle if you have taken medicine or are under the influence of alcohol or drugs.
- Never ride with your hands off the handlebars!
- Ride at an appropriate speed for the terrain and your riding capabilities.
- Under wet and slippery conditions, adapt how you cycle accordingly. In this case, you should ride more slowly and brake earlier and more gradually, as the braking distance becomes significantly longer.
- Pay particular attention to others on the road.



**Before the first ride, be sure to read the chapter “Before the First Ride”.**

This operating manual contains five different types of pointers – one providing important information about your new pedelec and how to use it, a second referring to possible damage to property and the environment, and a third type warning against potential falls and serious damage, including physical injury. The fourth pointer helps you to apply the proper torque so the parts don't loosen or break. The fifth pointer reminds you that it is necessary to study the operation and assembly manuals carefully.

When you see these symbols, there is always a risk that the described danger may occur.

The text which the warning covers always has a grey background.

The warnings break down as follows:



### Note

This symbol provides information about how to use the product or highlights specific parts of the operating instructions that are particularly important.



### Attention

This symbol warns of misuse which could result in damaging the product or the environment.



### Danger

This symbol indicates possible dangers to your health and life that could arise if specific actions or appropriate care is not taken.



### Important bolted connection

Precise torque must be applied here when tightening. To find out the correct tightening torque, you can either look on the bike part itself or in the table listing the tension values which is found in the original operating manual. In order to apply a precise torque, you must use a torque wrench. If you don't have a torque wrench, please contact an expert/Fischer customer service technician. Parts which do not have the correct torque could fall off or break! This may result in severe falls.



### Operating instructions

Read all of the instruction manuals delivered with the pedelec. If you are unsure about any of the topics addressed in this handbook, call our service hotline (Germany: +49 7 21 -97 90 25 60, Austria: +43 1 9073366).

## Intended Use



Pedelecs are means of transport designed to be ridden by one person. Transporting an additional person on the pedelec is only permitted in the framework of national legislation. If you would like to transport baggage, your pedelec needs to be fitted with suitable equipment. Children may be transported in suitable child seats or in trailers intended for this purpose. Pay attention to quality. Ensure that you do not exceed the maximum permissible weight.



Not every pedelec can be used everywhere and for every purpose. Before going on your first ride, be sure to read the information in the "Intended use" section of the original operating instructions. This information can be found on pages 18/19. If you are not clear about what type of pedelec you have and how it should be used, contact us via our service hotline (Germany: +49 721-97902560, Austria: +43 1 9073366)

The manufacturer and retailer shall not be liable for use that falls beyond the scope of intended use. This applies particularly to damage resulting

from failure to comply with the safety instructions, e.g., owing to

- use on terrain,
- overloading, or
- the improper repair of defects.

Pedelecs are not intended for hard impact, extreme use (i.e. riding over steps, jumps) and extreme sporting events (i.e. bike tricks, stunt jumping). Participation in competitions is only allowed when authorised by the manufacturer.

### Type 1: Trekking pedelecs

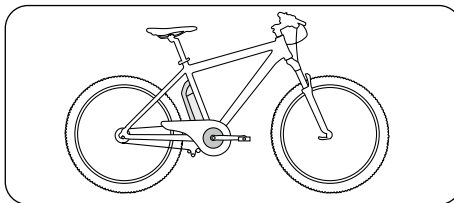

Pedelecs may be used on public roads and light terrain, such as country roads, if they are properly equipped in accordance with national regulations.

### Type 2: City and touring pedelecs

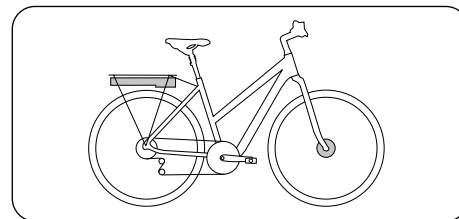

Pedelecs may be used on public roads and paved roads if they are properly equipped in accordance with national regulations.

### Type 3: Mountain bike pedelecs

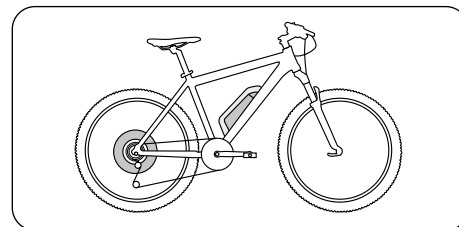

Pedelecs with suspension travel of up to 120 mm may be used on public roads and moderate terrain, such as country roads, trails and cross-country courses, if they are properly equipped in accordance with national regulations. You can ride over small obstacles like roots, stones or steps. You should always wear the appropriate safety equipment (eg. a suitable helmet and cycling gloves).

## Legal Regulations



Find out about the relevant national stipulations that apply to you.

According to EU law, a pedelec is under the same category as a bicycle and, therefore, has the same requirements.

Discussions on the obligation to wear helmets are ongoing. Before setting out on a ride, find out about the legal stipulations that apply to you.

## Children

### Children and pedelecs

Inform yourself on whether the child is old enough to ride the bike and has the necessary license to do so before allowing him or her to ride the pedelec. Pedelecs may only be ridden by children that are of legal age and possess the necessary permit. Children under 16 should not ride a pedelec.



Don't let children who are unattended ride the pedelec without first thoroughly instructing them on how to use it. Explain to children the dangers of using electrical devices.

### Carrying children/trailers for children



Child seats may only be used when they are mounted on the seat tube. Child seats **MUST NOT** be mounted on the luggage rack.

- Please only use safe, certified children's seats.
- The child must wear a helmet, their feet must be tucked in and protected from any possible contact with moving parts, such as spokes.

- A child seat changes the way your pedelec behaves when riding. Take note of the longer braking distances and the steering which could be less stable. Practice riding with a child seat in a safe area before taking to public roads.



Please comply with the manufacturer's instructions supplied with the seat.



In some countries, only children up to a certain age may ride in child seats. Find out about the legal regulations which relate to the age of the child and the rider.



Check whether the manufacturer provides a maximum permitted weight and a maximum permitted speed. If so, these values must be adhered to. Children under 16 are not legally permitted to ride a bike with a trailer in Germany.



Full suspension pedelecs are not suitable for use with trailers and child bike trailers! The bearings and attachments are not designed to withstand this sort of force. This could result in wear and damage with serious consequences.

## Unpacking

The Pedelec is shipped in a special closed shipping carton. Find a suitable space for performing the assembly.



The carton may be heavy.

Place the shipping carton upright on its bottom side. Then open it from one of the narrow sides and take the pedelec out of the carton.

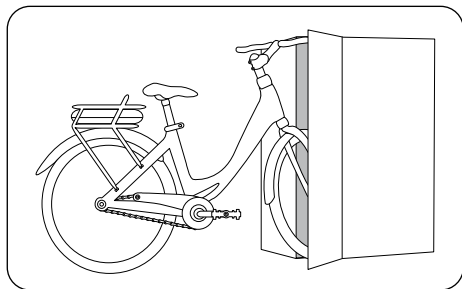

Be careful; metal staples may have been used to close the carton. Take care not to injure yourself on these staples.

In the shipping carton, you will also find an accessory box containing the pedals, power adapter for charging the battery and all operating instructions. You will also find the necessary tools for assembly (except for a torque wrench) in the box. The included tool is not suitable for first assembly. It is intended for use for makeshift repairs on the road!

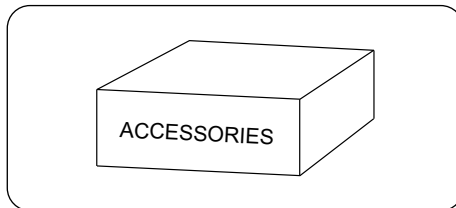

Remove the protective packaging material and cable ties with pliers or scissors.



Dispose of the packaging material properly and according to regulations at an appropriate disposal site.

## Assembly



Be sure to check that all screw connections and fasteners are securely fixed after assembly and adjustments are complete.

The vehicle has had lubricants applied at various locations. Always wear appropriate clothing and personal protective equipment, such as suitable gloves, when assembling.



Wear suitable protective clothing, protective gloves and protective goggles during all installation and maintenance work. Otherwise, dirt or injuries that may be caused by lubricants and auxiliary devices for the motor among other things may result.

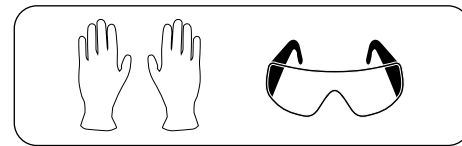

### Using quick releases

Quick releases are systems used in place of bolted connections to attach parts to the Pedelec. They consist of two parts: the quick release lever,

which provides the necessary clamping force, and the adjustment nut, which allows you to regulate the tightness. You can change the tightness of your quick release when it is open.

**i** Quick releases should be closed with the correct tightness. To close the lever correctly, pressure should be felt when it is half closed and, at the end, the ball of the thumb needs to be used to completely close it.

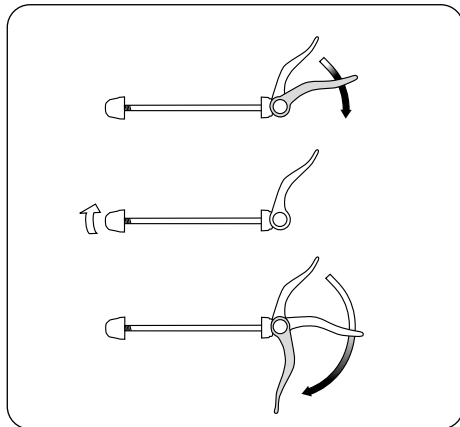

Loosening the adjusting nut

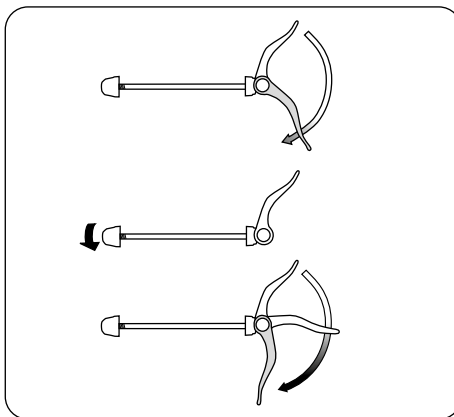

Tightening the adjustment nut



- All quick releases must be firmly closed before you set off.
- Make sure all quick release levers and axles are securely and properly fastened - even if the pedelec has only been left unattended for a short time.
- A closed quick release fastener must be folded in close to the frame, fork or seat post.
- When closed, the tip of the quick release lever must always be pointed backwards. This way, it won't open during the ride.

## Handlebars with a quill stem

1. Remove the cover from the stem clamping screw.

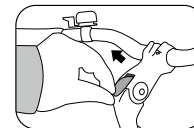

2. Loosen the stem clamping screw with a hex key, turning anti-clockwise. Only loosen it a few turns.

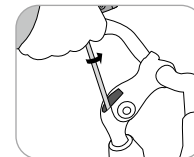

3. Align the stem so that the handlebars are at exactly a 90 degree angle, perpendicular to the front wheel.

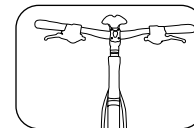

Information on the seat position and adjusting the stem and handlebars can be found in the original operating instructions on pages 18–20.

4. Use a torque wrench to tighten the stem clamping screw clockwise.

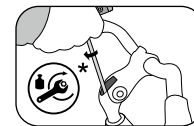

\* see page 39 in the original general instruction manual





You should use a 22–24 Nm torque wrench to tighten a quill stem and an adjustable quill stem. If a different tightening torque is marked on the component, use that torque instead.



The stem may be pulled out of the fork tube only as far as the maximum marking. At least 65mm of the shaft must remain inside the fork tube.

The screw for adjusting the stem angle can be found on the side or under the stem.

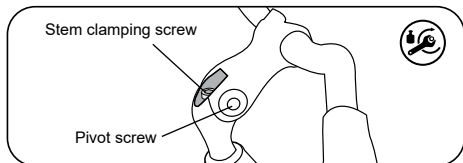

- Bolt on the side (pivot for adjusting the angle): 14–16 Nm
- Bolt under the stem: 18–20 Nm

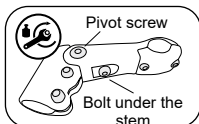

- Stem clamping screw beneath cover: 22–24 Nm

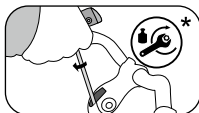

- 5. Replace the cover over the stem clamping screw.

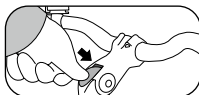

- 6. This is what your assembled handlebars and stem should look like when finished.

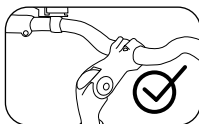

### Handlebars with an A-head stem

1. Loosen the stem clamping screws of the stem with a 5 mm hex key, turning anticlockwise. Only loosen it a few turns.

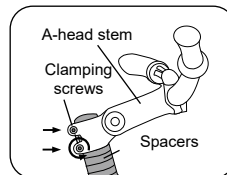

2. Align the stem so that the handlebars are at exactly a 90 degree angle, perpendicular to the front wheel.

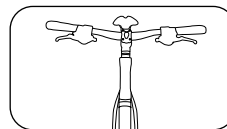

3. Now use a torque wrench to tighten the stem clamping screws clockwise.

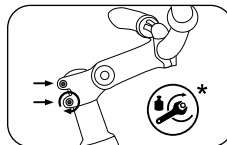

An A-head stem must be tightened to 14–16 Nm, and the pivot of an adjustable A-head stem to 14–16 Nm. If a different tightening torque is marked on the component, use that torque instead.

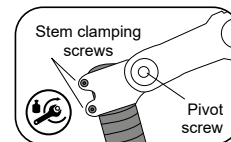

Stem clamping screw: 14–16 Nm  
Bolt on the side (pivot for adjustable-angle A-head stem): 14–16 Nm  
Bolt under the stem: 18–20 Nm

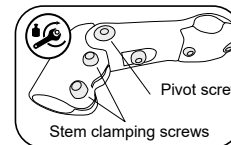

### Handlebars with a Speedlifter Twist

Using the Speedlifter, you can put the handlebars into the riding position with just a few movements and, depending on the model, also adjust the height of the handlebars.

1. Open the quick release lever of the Speedlifter ①.

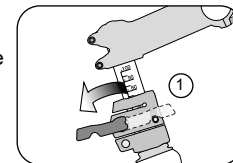

2. Turn the handlebars 90 degrees until the locking mechanism is visible and audibly clicks and the safety bolt ② on the stem is visible.

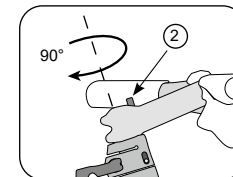

\* see page 39 in the original general instruction manual



If the safety bolt ② does not move smoothly or does not automatically extend from the stem even though the locking mechanism is engaged, this can usually be fixed with a little spray lubricant. If it still does not lock smoothly and automatically, do not ride it. If this happens, please call our service hotline.



Before riding, check that the stem is secure and will not twist. To do this, stand in front of the pedelec and place the front wheel between your legs. Grab the ends of the handlebars and try to turn the handlebars against the front wheel. The handlebars must be hard to turn! If the handlebars and stem can be twisted, do not ride it! First tighten the stem's fork tube clamping screws properly. This must be done using a torque wrench.

3. Adjust the handlebars / stem to the desired height ③. Pay attention to the maximum extension length.

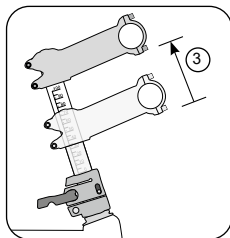

4. Close the quick release lever completely to fasten the handlebars ④.

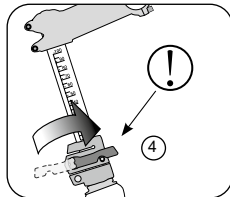

For a Speedlifter stem, this is the lowest clamping screw on the Speedlifter. The correct tightening torque in this case is 6–8 Nm.

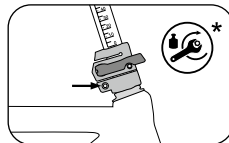

#### Screw-on pedals

The pedals are marked "L" for "left" and "R" for "right". Screw the right pedal into the crank arm on the right side and the left pedal on the opposite side.

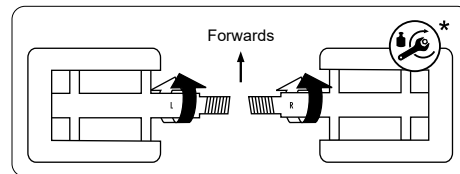
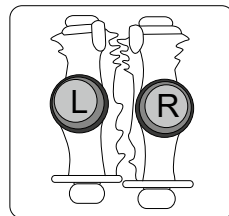

Apply assembly grease to both threads before assembling the pedals.



Note that the right pedal has a right-hand thread and therefore must be turned clockwise, while the left pedal must be turned anticlockwise. Use the included 15 mm open-end wrench or a special long pedal wrench. The appropriate tightening torque is 40 Nm.



If the pedals are mixed up or cross-threaded, the threads will be damaged. The pedals could break off from the crank, which can lead to a crash and severe injuries.



To correctly and safely adjust the saddle and the seat position, follow the instructions on pages 18 and 19 of the original operating manual. You can find the required tightening torques on the part or in the section titled "Tightening Torques" in the original instruction manual.

\* see page 39 in the original general instruction manual

## Clip-in pedals



Your Fischer pedelec with clip-in pedals is delivered with pre-assembled connectors on the cranks. Follow the instructions below to attach or remove the pedals.

### Attaching clip-in pedals

Place the pedal's hexagonal fastener head into the connector's hex socket and push the pedal into the opening ①. You should hear it click into place. Then pull the pedal outward and check that it is firmly attached ②.

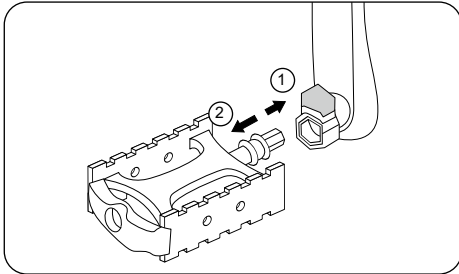

### Removing clip-in pedals

Using your left hand, draw the pull release on the connector upward ① and simultaneously remove the pedal from the socket ②.

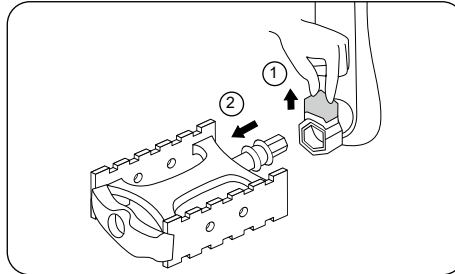

## Brake levers



When you squeeze the brake levers hard or all the way to the end of their leverage, the braking force can increase sharply! Please familiarise yourself with this new braking behaviour. Ensure that you receive and read the manufacturer's operating manual.



The brake levers should be set up so that your hands can safely and comfortably apply them as a straight extension of your arms.



Check the position of the brake levers before your first ride. Usually, the right brake lever operates the rear wheel brake and the left brake lever operates the front wheel brake. If you would like to swap the position of the brake levers on the handlebars, please contact a specialist retailer to do the work.

In order to allow people with smaller hands to safely apply the brakes, the levers can be set up to be closer to the handlebars using an adjusting screw (located in the lever). In some models it is possible to bring the brake levers closer to the handlebars, using special devices.

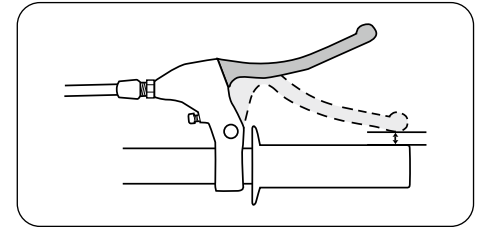

Set up the cable tension in such a way that the brake levers do not touch the handlebar grip, even when they are applied to their fullest extent!

## Adjusting the seat

Before you use your pedelec for the first time, the saddle position has to be adjusted to suit your body size. This will allow you to ride your bike safely.

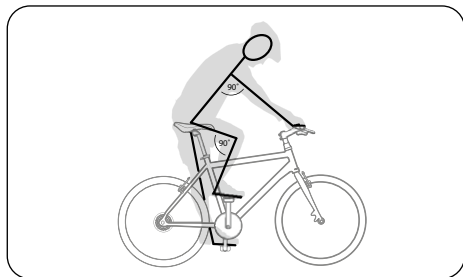

The height, horizontal orientation and inclination must be adjusted for the saddle and the height and orientation of the stem for the handlebars.

### Correct seat height

Adjust the saddle to the estimated correct height. Sit on the pedelec. Have someone help hold you in place or lean against a wall or railing. Move a pedal to its lowest position and place your heel on it. Your leg should now be straight. If you now place your foot in the correct riding position, your leg should be slightly bent. You are using the correct foot position for riding when your foot's widest point is above the pedal axle.

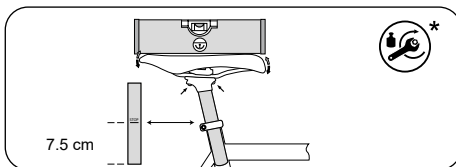

Never pull the seat post further out than the maximum mark on the tube frame! If there is no maximum mark, the seat post should always be at least 7.5 cm deep in the tube frame.



Children and people who feel insecure when riding should be able to touch the ground with their toes. Otherwise, when stopping they run the risk of falling and suffering serious injury.

### Saddle tilt

If you have adjusted the saddle height, the saddle inclination should be checked and adjusted as well. The surface of the saddle should always be level. You can perform this adjustment when the seat clamp bolts (saddle tilt) of the seat post have been undone.



Before you start riding, please test to see if your seat post and seat are secure. To do this, grasp the saddle at the front and back and attempt to turn it. It should not move.



For information concerning the installation and service of threaded and telescopic seat posts, read the manufacturer's service manual.

### Handle bar position / Stem



Only experts should work on your handlebars and stem.



You should always be able to safely reach and use grips and controls. Please ensure that all cables and lines are long enough to allow you to turn the handlebars in every possible way.



For detailed information about your stem, please read the operating instructions supplied by the manufacturer.

\* see page 39 in the original general instruction manual

## Suspension

If your pedelec is equipped with suspension elements, they must be adjusted to suit the rider's weight and intended purpose. Such work requires specialist knowledge and experience and should only be performed with the help of a specialist/Fischer service technician.



Carefully read the enclosed manual concerning the suspension system to your pedelec.



Tighten all screws to the recommended torque to avoid screws falling out or breaking and parts falling off.



Perform the following test before the first ride: Lift your pedelec up slightly and drop it onto the ground from about 10 cm in the air. If you hear loud rattling or other unusual noises, check all bolted connections. If you still hear rattling and unusual noises after checking, please contact our service hotline (Germany: +49 721 97902560, Austria: +43 1 9073366) before trying to ride it.

Now perform the check from the section "Before your first ride" in the original operating instructions.

## Instructions about electrics and electronics



Modern battery technology is high tech. It is very powerful. Using it requires particular care, knowledge and experience. Please read all the instructions in the original instruction manual on how to handle the battery. Be careful when handling the battery. It is heavy. Due to its high energy density, it is more dangerous if handled incorrectly.



Don't let children who are unattended ride the pedelec without first thoroughly instructing them on how to use it. Explain to children the dangers of using electrical devices.



Keep in mind that on a pedelec you are travelling much faster than you would on a bicycle without an electric drive. Other road users may misjudge this. Only use your pedelec for the intended use (page 14). If you are unclear about the pedelec's intended uses, please contact our service hotline (Germany: +49 721-97902560, Austria: +43 1 9073366).



Your pedelec has a "pushing aid" function, whereby it moves at up to 6 km/h without the need to pedal yourself. The pushing aid function works to assist you if you, for example, have to climb a steep ramp from an underground car park or underpass. Do not use it to ride the bike.



Note that if the road surface or ground are slippery (due to rain, snow, sand, etc.), there is a risk that the drive wheel of your pedelec may skid and slide.

## Charging process



In some models you can charge the battery while it is mounted in the Pedelec. Please read the system manual in this regard.



Before using your pedelec, you may need to configure the display panel. To do this, please read the "Initial display configuration" section on page 16 of the system manual.

## Charger

- Only use the charger that came with your bike or one from the same manufacturer.
- Only use the charging device in dry conditions and do not cover it when in use, to avoid the danger of short-circuits or fire.
- Read the instructions on the charger before you start charging the battery.

## Maintenance and care



Always remove the battery before doing any kind of work on the electrical system to your pedelec.

## Before the first ride



Practice operating and riding your pedelec in a quiet and safe place before you take to public roads!

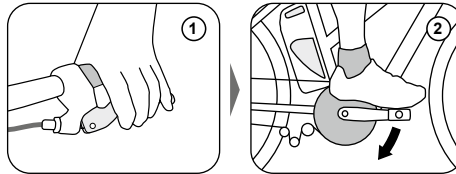

Always squeeze the brakes of your pedelec before placing a foot on the pedal. The electric engine starts working as soon as you begin to pedal. This boost is surprising to begin with, and can lead to falls or cause dangerous traffic accidents and injury to occur.

Ensure that the pedelec is ready for use and adjusted to fit your body.

That means:

- The seat is comfortably and securely positioned and secured (see page 18/19)
- The handlebars are comfortably and securely positioned and secured (see page 20)
- Mounting and adjusting the brakes (see page 22)
- Making sure the brake handles are easily accessible (see page 22)

- Familiarising yourself with the assignment of brake handles to the front (left brake handle) and rear wheels (right brake handle).
- Fastening the wheels securely onto the frame and the fork
- Checking that the tyre pressure is correct

It is also necessary for you to check the following components of your pedelec:

- The battery is secure
- Ensure the battery is sufficiently charged for the planned trip

Familiarise yourself with the functions of the operating element.



Modern braking systems might be more powerful or have a different functionality than those that you are used to. Practice operating the brakes in a safe area without traffic before you start a journey. Also remember that the effectiveness of brakes can be different to what you are used to in wet conditions or on slippery surfaces. Adapt the way you cycle for slippery surfaces with possibly longer braking distances.



If rubber or plastic pedal covers have been put on your pedelec, familiarise yourself with their grip. When wet, rubber and plastic pedals are very slippery.

Make sure the wheels are securely fastened in the frame and fork. Check that the quick releases, quick release axles and all important nuts and bolts are secure.

Lift your pedelec up slightly and drop it onto the ground from about 10 cm in the air. If you hear rattling or other unusual noises, please contact our service hotline (Germany: +49 721 97 90 25 60, Austria: +43 1 9073366) before trying to ride it.

Check the air pressure in the tyres. You will find information as to the correct tyre pressure on the sides of the tyres. Please adhere to the required minimum and maximum pressure!

As a general rule of thumb when you are out on a ride, you can check the tyre pressure by doing the following: If you place your thumb on a pumped-up tyre, you should not be able to significantly change its shape by applying pressure.

In addition, check whether there is an indication of maximum tyre pressure stated on the rim. If so, this specified pressure must not be exceeded.

## Mechanical components

### Back pedal brakes

If your pedelec is equipped with back pedal brakes, brake by pushing the pedals backwards instead of forwards. This means that your pedelec will not freewheel and you are unable to rotate the pedals backwards freely as you otherwise can.



The safest way to brake using back pedal brakes is when the pedals are at the same height parallel to the ground. If one pedal is at the top and one at the bottom, it is difficult to produce enough force to brake effectively.



The effectiveness of back pedal brakes can deteriorate substantially on long inclines! This type of braking system can become very hot from continuous braking. You should also use the front brake to slow down on long inclines. Wait until the back pedal brake has cooled down and do not touch the brake drum.

### Chain



To ensure that the chain and gears work safely, the chain has to have a certain level of tension. Derailleur gear systems tense the chain automatically. In the case of hub gears, chains which are too loose must be tightened. It might otherwise jump off the gears and lead to a fall.

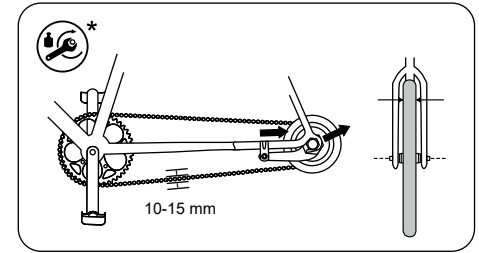

### Brakes



You can find information about the brakes on your pedelec and how to use them in the original operating manual, the manufacturer's manual and on their websites.

\* see page 39 in the original general instruction manual

## Hydraulic Disc Brakes



The brake lever may not be applied if the pedelec is on its side or upside down. Otherwise air bubbles can enter the hydraulic system which could cause the brakes to fail. After transporting the pedelec, check if the pressure point of the brakes seems softer than before.

## Gear change system



Easy-to-understand video instructions for adjusting derailleurs and hub gears can be found on our website at: [www.fischer-fahrrad.de/mediathek](http://www.fischer-fahrrad.de/mediathek)

Your pedelec's gears have been carefully assembled and adjusted by the manufacturer. In rare cases, a gear may become misaligned while in transport. You can tell that this is the case if the individual gears do not easily click into place, the chain slips or a permanent clicking or slight rattling occurs while riding it. If this happens, turn the adjusting screw on the gearshift handle a quarter turn in either direction and try again to see whether the gear clicks in more easily or whether there is less noise when riding it. If it has become easier to shift gears, repeat the adjustment until the gears are working properly and quietly. If it becomes worse and the noises

become louder, turn the adjusting screw in the other direction.



You can get more information about the brakes on your pedelec in the operating manual provided by your manufacturer or on the manufacturer's website.

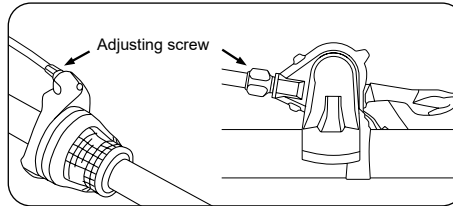

## Loose/mounted accessories



You always have to fit the enclosed accessories in line with the guidelines and instructions.



You have to ensure that screwed connections are secured with the correct torque.



You can find more information about the parts on your pedelec on the manufacturer's website.

## Luggage rack



Luggage load changes the behaviour of your pedelec. It extends the braking distance, among other things. This may lead to severe accidents. Please adjust your riding style to this, i.e. brake earlier and anticipate more sluggish steering. Only transport baggage on racks intended for this purpose! Never attach a baggage rack to the seat post! It is not designed for this purpose. Overloading of the seat post by a luggage rack can break the seat post and lead to serious accidents!



## After Sales Service

### Service in Germany and Austria only:

Für Fragen zu Ihrem Pedelec kontaktieren Sie bitte unsere Service Hotline für Deutschland **+49 721 97902560** oder unsere Service Hotline in Österreich **+43 1 9073366**.

### Service in the Netherlands and Belgium only:

Je hebt een probleem ontdekt met je e-bike? FSN+, als partner van FISCHER, staat hier aan uw zijde!

Registreer uw fiets/e-bike op de website van FSN+ en ervaar zorgeloze fietstochten met het volledige ser-vicepakket! U kunt ook telefonisch contact met ons opnemen op het volgende telefoonnummer: **+800-32797834**

**Fischer-Service-NL@mts-gruppe.com**

Vous avez trouvé un problème avec votre e-bike ? FSN+, en tant que partenaire de FISCHER, est à vos côtés !

Enregistrez votre e-bike sur le site web de FSN+ et faites l'expérience de tours à vélo sans soucis grâce au pack de services complet ! Vous pouvez également nous contacter par téléphone au numéro suivant : **+800-32797834**

**Fischer-Service-B@mts-gruppe.com**

### All other countries:

**EN** Dear customer, if you have any questions or problems with your FISCHER e-bike, please first contact the company/store where you purchased the FISCHER e-bike directly. There you will get an answer.

**FR** Cher client, si vous avez des questions ou des problèmes avec votre E-Bike FISCHER, veuillez d'abord contacter directement la société/succursale où vous avez acheté le E-Bike FISCHER. Vous y obtiendrez une réponse. Ou écrivez à l'adresse électronique suivante

**Fischer-Service-F@mts-gruppe.com**

**ES** Estimado cliente, si tiene alguna pregunta o problema con su FISCHER E-Bike, por favor contacte primero con la compañía/sucursal donde compró la FISCHER E-Bike directamente. Allí obtendrá una respuesta. O escriba a la siguiente dirección de correo electrónico

**Fischer-Service-E@mts-gruppe.com**

**PT** Caro cliente, se tiver quaisquer perguntas ou problemas com a sua e-bike FISCHER, por favor con- tate primeiro a empresa/loja onde adquiriu directamente a e-bike FISCHER. Ai obterá uma resposta.

**FI** Hyvä asiakas, jos sinulla on kysymyksiä tai ongelmia FISCHER-sähköpyöräsi kanssa, ota ensin yhteyttä yritykseen/myymälään, josta ostit FISCHER-e-pyörän suoraan. Siellä saat vastauksen.

**SE** Kära kund, om du har några frågor eller problem med din FISCHER e-cykel, vänligen kontakta först företaget / butiken där du köpte FISCHER e-cykel direkt. Där får du ett svar.